

## » Total Contact Valve

### Valve

#### Supplier:

Hosmer Dorrance Corporation (Fillauer)

#### Features & Benefits:

- Operation same as the Red Dot Air Expulsion Valve (TCV-100)
- Available in two lengths to accommodate thick and thin-walled prosthesis

#### Specifications:

- Materials: *Stainless steel with acrylic inset*
- Sizes: *Short and Long*
- Diameter: *3.2cm (1¼")*
- Lengths: *Short = 2.06cm (13/16")*  
*Long = 2.86cm (1⅛")*

#### Indications:

- Transfemoral valve

#### Call Points:

- Prosthetist
- Prosthetic technician

#### Warranty:

- 24 months, against manufacturers defects



Item No.	Model	Description	Size	Material	Length	Diameter
HD-51952	TCV-200L	Suction valve	Long	Stainless steel	2.06cm (13/16")	3.2cm (1¼")
HD-51953	TCV-200S	Suction valve	Short	Stainless steel	2.86cm (1⅛")	3.2cm (1¼")
HD-51969	TCV-250L	Insert for TCV-200L	Long	Acrylic		
HD-51970	TCV-250S	Insert for TCV-200S	Short	Acrylic		

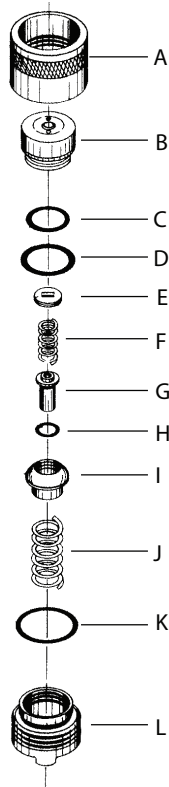

**Total Contact Valve » Parts**

	<b>Item No.</b>	<b>Description</b>	<b>For Model</b>
A	HD-51954	Body	TCV-200L
A	HD-51955	Body	TCV-200S
B	HD-51958	Core cap	TCV-200L
B	HD-51959	Core cap	TCV-200S
C	HD-51962	O-ring	
D	HD-51964	Cap seal	
E	HD-51967	Core plug	
F	HD-51960	Release spring	
G	HD-51966	Button	
H	HD-51965	Button seal	
I	HD-51957	Core sleeve	
J	HD-51948	Spring standard	
K	HD-51961	Body seal	
L	HD-51968	Core body	