

## » WE Friction Wrist

### Prosthetic Wrist

**Supplier:**

Hosmer Dorrance Corporation (Fillauer)

**Features & Benefits:**

- Permits terminal device to be rotated to any position
- Friction is easily adjusted by set screw in body of wrist
- Friction insert has stainless steel lead threads and is replaceable

**Specifications:**

- Types: *With or without laminating ring\**  
*(\* Laminating ring available for Medium and Adult sizes only)*
- Sizes: *Child, Medium and Adult*
- Diameter: *Child= 3.8cm (1½")*  
*Medium= 4.4cm (1¾")*  
*Adult= 5.1cm (2")*
- Weight: *Child= 42g (1.5oz)*  
*Medium= 57g (2oz)*  
*Adult= 74g (2.6oz)*
- Thread: *Standard ½–20*

**Indications:**

- Transradial and transhumeral amputations

**Call Points:**

- Prosthetist
- Prosthetic technician

**Warranty:**

- 18 months, against manufacturers defects



Item No.	Model	Description	Size	Thread	Diameter	Weight
HD-52147	WE-200N	Friction wrist	Child	Standard ½–20	3.8cm (1½")	42g (1.5oz)
HD-52156	WE-300N	Friction wrist	Medium	Standard ½–20	4.4cm (1¾")	57g (2oz)
HD-52160	WE-500N	Friction wrist	Adult	Standard ½–20	5.1cm (2")	74g (2.6oz)
HD-58688	WE-300LR	Friction wrist with laminating ring	Medium	Standard ½–20	4.4cm (1¾")	65.2g (2.3oz)
HD-58684	WE-500LR	Friction wrist with laminating ring	Adult	Standard ½–20	5.1cm (2")	82.2g (2.9oz)

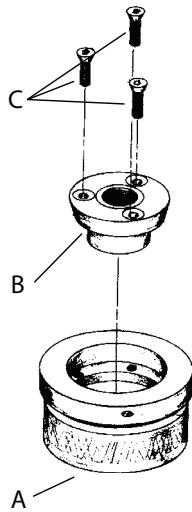

**WE Friction Wrist » Parts**

Item No.	Description	For Model
A HD-52166	Body	WE-500N
A HD-52157	Body	WE-300N
A HD-52148	Body	WE-200N
B HD-52151	Insert assembly	WE-500N, WE-300N & WE-200N
C HD-52152	Screw	WE-500N, WE-300N & WE-200N
H HD-52154	Allen wrench	
HD-52155	Set screw	

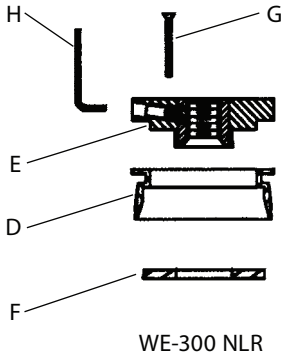

**WE Friction Wrist With Laminating Ring » Parts**

Item No.	Description	For Model
D HD-59522	Laminating ring	WE-500NLR
D HD-59523	Laminating ring	WE-500NLR
E HD-58685	Body assembly	WE-500NLR
E HD-58689	Body assembly	WE-500NLR
F HD-58287	Nut plate	WE-500NLR
G HD-58283	#4-40 screw (4 required)	WE-500NLR
G HD-58682	#4-40 screw (4 required)	WE-500NLR
H HD-52154	Allen wrench	
HD-52155	Set screw	